

**Liquid-to-Liquid Thermoelectric Assembly**

0000-LL-060-12-00

**Specifications:**

Cooling Power $Q_{cmax}$ (W)	60
Running Current (A)	4.2
Nominal Voltage (V)	12
Max Voltage (V)	15
Power Input (W)	50
Operating Temperature (°C)	-10 to 63
Weight (kg)	0.5
Performance Tolerance	±10%

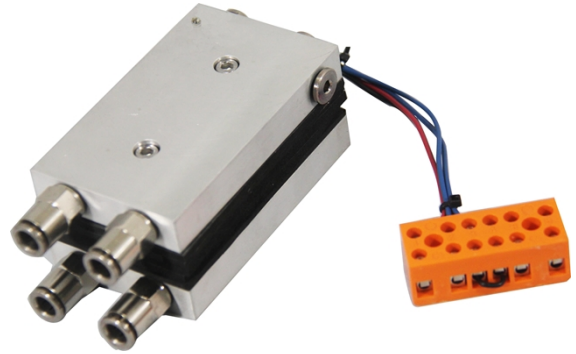

**Features**

- Compact design
- Precise temperature control
- Reliable solid-state operation
- DC operation
- RoHS compliant

**Applications**

- Analytical instrumentation
- Medical diagnostics
- Photonics laser systems
- Industrial instrumentation
- Food and beverage cooling

All products are manufactured in an ISO 9001:2008 & ISO/TS 16949:2009 certified facility and are designed to meet the cooling needs of many thermal management applications in the medical, analytical, industrial and telecom markets.

**Performance Curve**

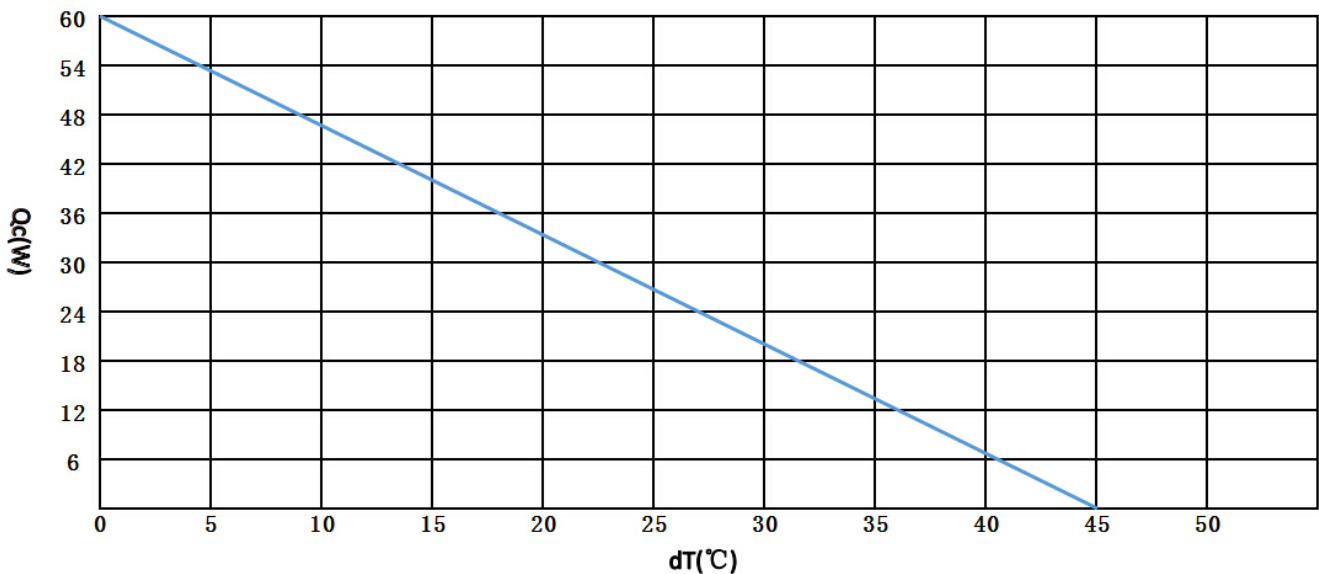

Mechanical Drawing

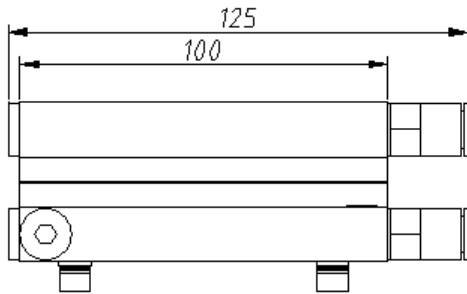

Cold side

Hot side

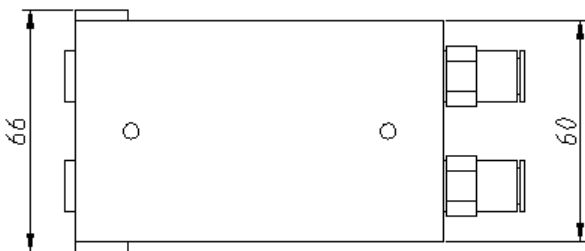
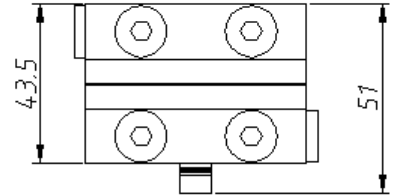

Quick couplings for outer diameter 8 mm pipe.

Wiring Schematic (Power Connector)

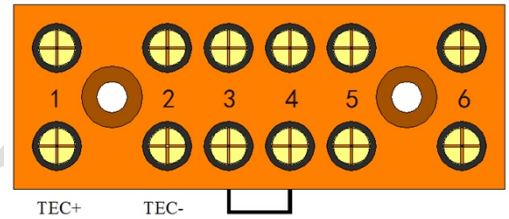

**Notes:**

For indoor use only.

Overheating Thermostat:  $75^{\circ}\text{C} \pm 5^{\circ}\text{C}$  on hot side heat sink surface.

**Address:** 5/F Xinfei Building 28<sup>th</sup> Xiangming Road, Torch (xiang'an) Hi-tech Zone, Xiamen Fujian China.

**Sales Tel:** +86-592-352 1988

**Fax:** +86-592-352 1989

**Postcode:** 361 011

**Web:** [www.pengnantech.com](http://www.pengnantech.com)